

# II Instructions



This machine complies with Directives 98/37/CE, 89/336/CE, 2005/88/CE.

The weighted average quadratic value, in frequency, of acceleration that the operator's upper limbs are exposed to is below 2.5 m/s<sup>2</sup>.

The weighted average quadratic value, in frequency, of acceleration that the operator's body (feet or seated part) is exposed to is below 0.5 m/s<sup>2</sup>.

This crane is designed as a lifting device with hook in materials according to class S0 – HC1 in conformity with EN 13000 standards, for moving mainly in worksites, on hard ground and gradients up to 18%.

For greater distances (over 10 km) the crane must be carried on a trailer or flatbed truck.

Driving on public roads is permitted in compliance with current laws and regulations.

This crane can be used at temperature not lower than -20°C and not higher than +45°C, according to its configuration.

The machine does not comply with the provisions of directive 94/9/CE (ATEX), it is thus not suitable for use in potentially explosive environment.

It is also recommended not to use it in the presence of strong magnetic fields.

This crane is designed to operate in winds of up to 30 kph. Use of the crane in dusty conditions is subject to taking all the necessary precautions for safeguarding the operator, and suitable increase in the frequency of maintenance and lubrication intervals.

Max. sound pressure LpA, measured inside the cab at the height of the operator's ears, with door closed, crane stopped and with the engine at 3/4 max. rpm is 78 dB (A).

## ***Installation of accessories***

Whenever, after the **FIRST** start-up and subject to the permission of TEREX, supplementary lifting equipment (extensions or winches) is installed on the mobile crane, the user must:

1. have the necessary adjustments and calibrations carried out.
2. have correct operation of the accessories and relative safety devices checked.

The crane model and manufacturer's reference number are located near the front axle on the outside of the main frame beam on the right, above the tool-box.

The crane data plate is located on the outside of the operator's cab.

Macchina Machine	<input type="text"/>	Modello Model	<input type="text"/>
Matricola Serial No.	<input type="text"/>	Anno costruzione Manufacturing year	<input type="text"/>
Potenza Power	<input type="text"/>		
Massa totale Total weight	<input type="text"/>	Kg	
Portata massima Max lifting capacity	<input type="text"/>	t	
		 <b>LWA</b>  <b>XXXdB</b>	
<b>TEREX ITALIA S.r.l.</b> Via Cassoletta, 76 40056 Crespellano - BO - Italy			

The data on the dataplate are guideline and do not correspond to real conditions

The plate giving details of DGM type-approval for road use (where applicable) is located inside the cab. It gives the type-approval data and vehicle weight in running order for road travel.

<b>COSTRUTTORE:</b>	<input type="text"/>
TIPO	<input type="text"/>
N. OMOLOG.	<input type="text"/>
N. IDENTIFICAZ.	<input type="text"/>
MASSA TOT. AMMISSIBILE	<input type="text"/> kg
CARICO AMM. ASSE ANT.	<input type="text"/> kg
CARICO AMM. ASSE POST.	<input type="text"/> kg
MASSA RIMORCHI AMM.:	<input type="text"/>
POTENZA MOTORE:	<input type="text"/>
VALORE CORRETTO COEFFICIENTE DI ASSORBIMENTO:	<input type="text"/> (m <sup>-1</sup> )
ANNO DI COSTRUZIONE:	<input type="text"/>
<b>TEREX ITALIA S.r.l.</b>	Via Cassoletta, 76 40056 Crespellano (BO)

The owner of the machine or the person hiring it must ensure that the operator has:

- received all the necessary instructions for correct and safe machine operation;
- fully understood and memorized all the instructions in this manual.

## IMPORTANT

**For safe crane operation, use the load capacity tables given in this manual or located in the operator's cab.**

## ATTENTION

***Before starting the engine:***

Become familiar with the safety messages in this manual.

Read all safety signs on the machine and make sure no one is standing near the machine.

Practice using the controls before operating the machine.

It is the user's responsibility to ensure that the manufacturer's instructions on machine operation, and compliance with the applicable laws and regulations.

## ATTENTION

The warranty will be invalidated in case of negligence, lack of maintenance, improper use of the material by the purchaser or his personnel, non-compliance with the technical instructions relevant to the warranty.

*N.B.: If the manuals and load tables are damaged or lost, request copies from your dealer or directly from the manufacturer.*

## WARNING

### **BUNGEE JUMPING FROM CRANES IS DANGEROUS**

TEREX Italia, designs, manufactures and sells safe and reliable products for handling materials, and **NOT PERSONS**.

Therefore, we believe that using the crane for lifting, lowering or moving persons for bungee jumping is dangerous and highly inadvisable.

**Such improper use of the products is neither envisaged nor approved by TEREX Italia.**

**Our products are not designed, manufactured, tested or devised to carry personnel.**

Lifting persons for bungee jumping is inherently dangerous; make sure to read the section on Safety Regulations to know the risk of injury, and the warnings against using cranes to lift persons.

All Dealers and Distributors are requested to use every reasonable means to immediately warn all potential users, purchasers and hirers of cranes that **BUNGEE JUMPING FROM THE CRANE IS DANGEROUS**. Dealers and Distributors are also advised not to knowingly sell and rent cranes for bungee jumping, as this constitutes serious improper use of the product.

***REMEMBER: BUNGEE JUMPING FROM CRANES IS DANGEROUS.***

#### **The use of the crane with:**

- shovels, grabs, magnets or similar equipment
- Vibrating equipment.
- Demolition equipment.

**shall be authorised from TEREX.**

It is also strictly prohibited to use the crane when visibility is poor. The operator must be in optimal physical condition, be able to read and understand the manual and the crane load tables, and have specific knowledge of the crane and basic training on the operation of self-propelled industrial equipment.

Holding of a driving license is compulsory in compliance with the current laws and regulations.

## IMPORTANT

All the lubrication and maintenance operations must be carried out to ensure the safety and reliability of every type of vehicle. Some of these operations, described in the Maintenance Manual, require special equipment and technical knowledge. Non-compliance with the lubrication and maintenance instructions can result in serious accidents.

### **CAREFULLY READ ALL THE SAFETY INSTRUCTIONS BEFORE LUBRICATING AND SERVICING THE MACHINE.**

Preventive measures against possible hazards in maintenance operations are outlined in the section on "Safety". Warnings against some hazards that can cause serious accidents are also affixed to the machine.

TEREX Italia is not in a position to know how maintenance operations are performed, or all the risks relevant to particular methods, and therefore is unable to advise maintenance personnel. Therefore, anyone using an unsuitable method or a tool not recommended in the Manual must previously make sure there are no risks for the operator or others, that the machine will not be damaged and safety is not compromised.

## IMPORTANT

**In the event of an accident, no claims against TEREX Italia will be accepted unless a person authorized by TEREX Italia has written a report on the actual circumstances, before the machine is removed from the scene.**

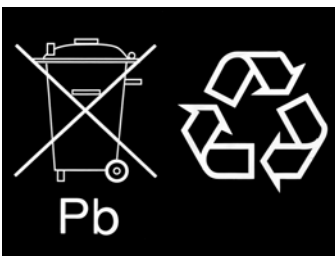

## IMPORTANT

**When the machine is disposed of, contact local reclamation entities to ensure correct disposal of the various components.**

**Pay utmost attention to the counterweights that could contain lead.**

**List of stickers**

**IMPORTANT:** Do not remove the stickers affixed to the crane. Worn or deteriorated stickers must be replaced.

The following are safety stickers and must be strictly respected.



**NO STANDING:** no standing in the machine's operating range during manoeuvres.



**NO ENTRY:** unauthorized personnel not allowed



**WARNING:** do not use naked flames



**WARNING:** moving parts





**WARNING:** moving parts with danger of crushing



**WARNING:** general danger



**WARNING:** flammable



**WARNING:** danger of falling



**WARNING:** pressurized components (1), high temperature (2), danger of fire (3), moving parts (4).



**WARNING:** pressurized hydraulic accumulator; before performing any maintenance consult the instruction manual for the relative procedures.



**COMPULSORY:** read the Operator's Manual located in the operator's cab



**WARNING:** emergency exit



Outrigger beam telescoping

## Position of decals on the machine

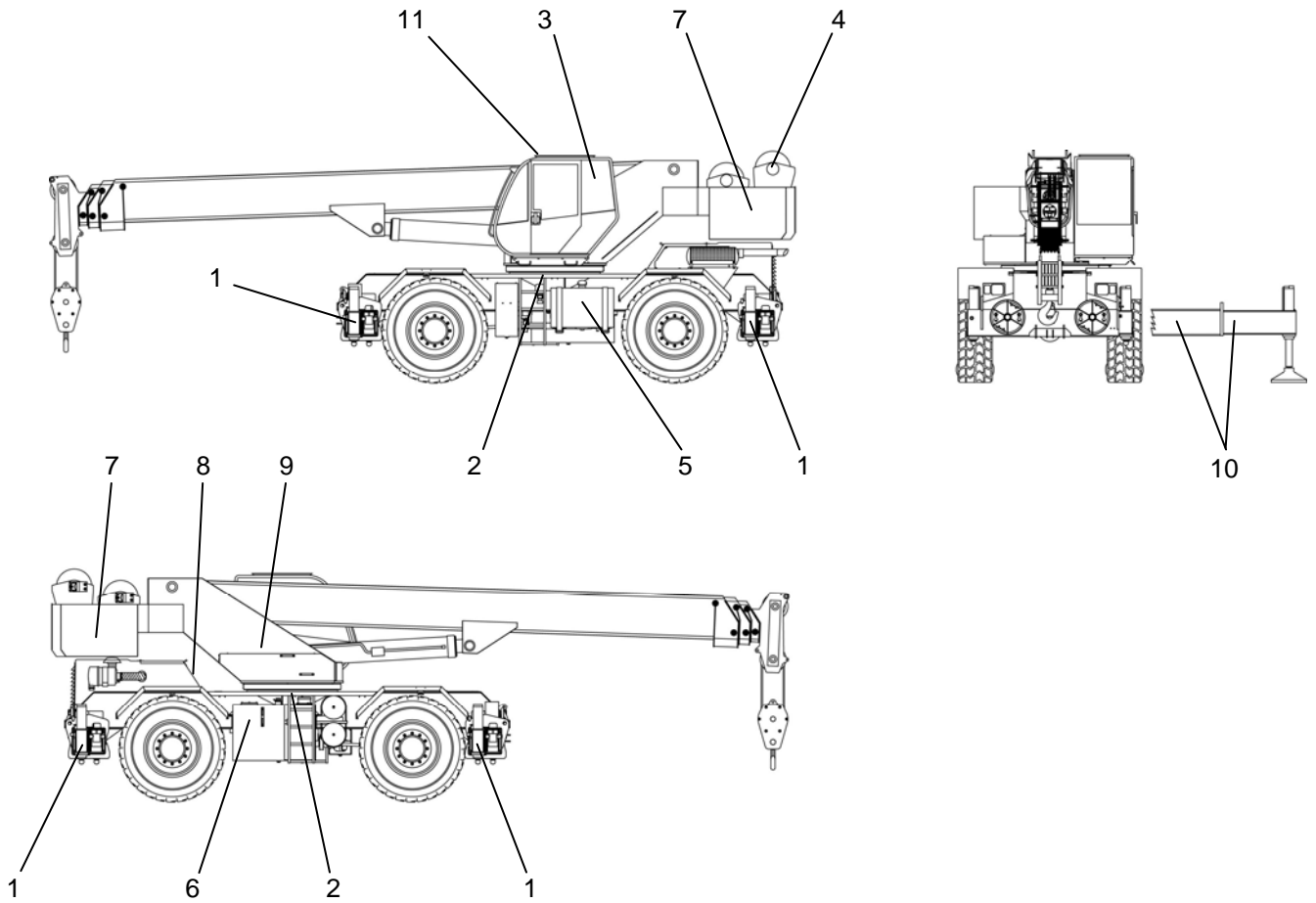

1		7	
2		8	
3		9	
4		10	
5		11	
6			