

D 40

Transport systems with driving reversibility

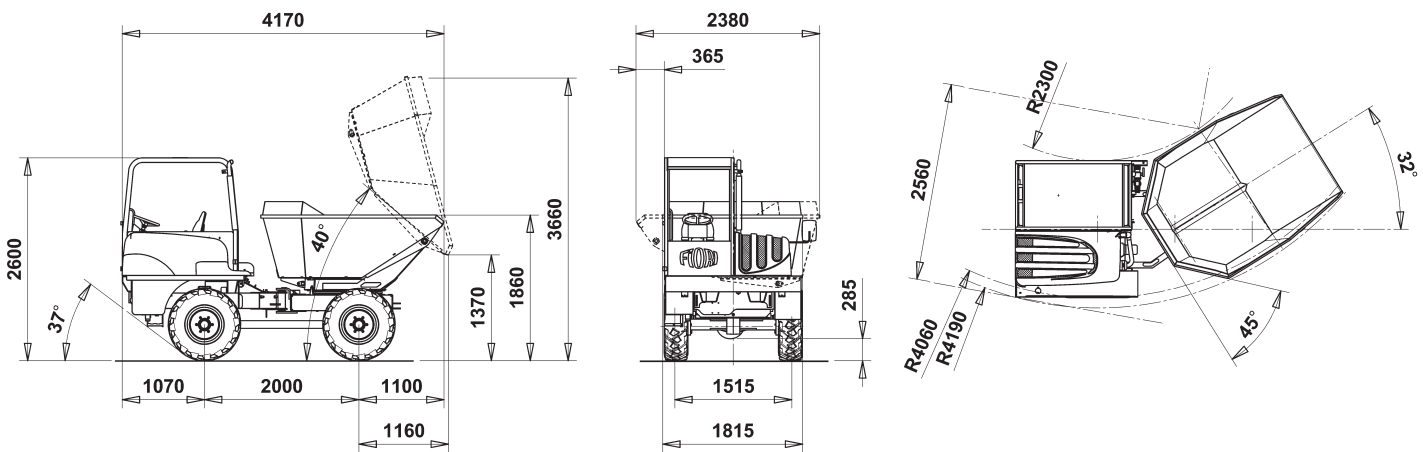

DIESEL ENGINE

YANMAR 4TNV88, naturally aspirated
Mechanical control with direct injection
Max. power 36.9 kW - (49 Hp)
Adj. power 32 kW (44 Hp) at 2600 rpm
Max. torque 139 Nm at 1200 rpm
Bore/stroke: 88/90 mm
4 cylinders - total displacement 2190 cc
Water cooling, dry air filter

ELECTRIC SYSTEM

Alternator: 12 V - 40 A
Battery: 12 V - 80 Ah (400 A)
Road light and signalling system.

4X4 FOUR-WHEEL DRIVE

Hydrostatic "automotive" transmission with variable displacement pump and variable displacement hydraulic motor with electro-hydraulic control, and reverse gear control on the steering wheel. Mechanical gearbox for "working speed" and "road transfer" speed, with mechanical control.

SPEED

4 forward gears	4 reverse gears
I° 0 - 5,0 Km/h	0 - 5,0 Km/h
II° 0 - 7,2 Km/h	0 - 7,2 Km/h
III° 0 - 14,2 Km/h	0 - 14,2 Km/h
IV° 0 - 20,2 Km/h	0 - 20,2 Km/h

Traction / weight ratio 55%

AXLES AND WHEELS

Front load-bearing, oscillating ($\pm 7^\circ$) and steering with planetary reduction gears on the wheel hubs.
Rear load-bearing and steering with planetary reduction gears on the wheel hubs and directly flanged gearbox.
Tyres 12.0/75-18 12PR

BRAKES

Internal oil-bath disc service and emergency brakes acting on the 4 wheels, activation with pump on independent dual circuit.
Drum parking brake on the front axle with lever control.

STEERING

Assisted by means power steering acting on 2 half-frames by means of two opposed jacks.

EQUIPMENT HYDRAULIC SYSTEM

Gear pump
Max. flow rate: 35 litres/min.
Maximum pressure: 170 bar
2 - elements distributor.
Aluminium heat exchanger for hydraulic oil cooling.
Pressurised closed-circuit intake with oil filter replaceable from the outside.

DUMP BODY

Dump body tilting by means of 1 double-acting jack. Orientation over 180° for trilateral unloading by means of two opposing jacks.
Struck capacity 2000 litres
SAE heaped capacity 2700 litres

CAB

Open cab in compliance with ROPS (ISO 3471) and FOPS (ISO 3449) criteria.
 180° pivoting driving post. Anatomic seat with flexible suspension and height adjustment, seat belts.
Driving and equipment controls with ergonomic arrangement.

SERVICE REFILL CAPACITIES

Fuel tank: 46 litres
Total hydraulic system capacity: 50 litres
Engine oil: 3,4 litres

WEIGHTS

Operating weight: 3400 kg
Max gross weight: 7400 kg
load-carrying capacity: 4000 kg

Valid as of 01/2012. All the data are purely indicative and may change without prior notice.